

.062 ALUMINUM CLOSURE
WITH POP RIVETS AT 24" O.C.
(FIELD DRILLED BY INSTALLER)

STAND-OFF
WELDED TO PURLIN

1/4-14 STAINLESS STEEL
HEX HEAD SCREWS WITH
SEALED WASHERS AT 12" O.C.

3 FINGERED GASKET
PURLIN TIE CLIP

MW GASKET

PINNACLE 900 PURLIN

ALUMINUM PLATE
WELDED TO RAFTER

1/2" SS ANCHOR
4 PER RAFTER
(BY WASCO)

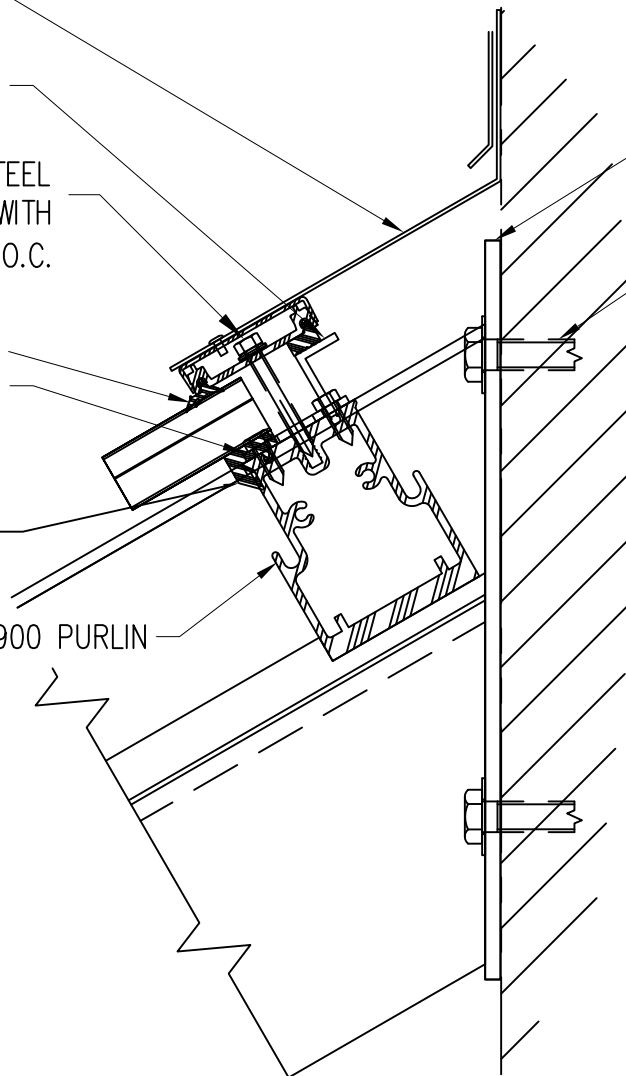

WASCO PRODUCTS, INC.

85 SPENCER DRIVE UNIT A, WELLS, MAINE 04090
(207) 216-4500, FAX (207) 216-4566

**PINNACLE 900 MULTIWALL
LEAN-TO HEAD
DETAIL**

D9